



MEDIA KIT

Gvoke™, Gvoke HypoPen™, Gvoke HypoPen 2-Pack™, Xeris Pharmaceuticals® and their associated logos are trademarks of Xeris Pharmaceuticals, Inc.

Copyright ©2020 Xeris Pharmaceuticals, Inc. All rights reserved.

TABLE OF CONTENTS

	Page
Advisement of Attached Media Kit.....	3
Introduction.....	4
Posting Guidelines.....	5
Digital Platforms.....	6
Assets	
Gvoke HypoPen™ Availability Press Release.....	7
About Gvoke.....	11
Xeris Leadership Quotes.....	13
5 Things to Know About Gvoke.....	14
Frequently Asked Questions.....	15
Visual Assets	
Gvoke HypoPen.....	19
Gvoke™ Pre-Filled Syringe.....	24

ADVISEMENT OF ATTACHED MEDIA KIT

This is a media kit created to assist interested parties in developing and disseminating information through traditional or online media channels regarding Xeris Pharmaceuticals' (Xeris) availability of the Gvoke HypoPen™.

As a pharmaceutical manufacturer, communications regarding Xeris' products are subject to significant limitations. The U.S. Food and Drug Administration (FDA) will hold a manufacturer responsible for statements made by third parties if they have a relationship with the company.

INTRODUCTION

On July 1, 2020, Xeris Pharmaceuticals announced the availability of Gvoke HypoPen™ – the first and only autoinjector for the treatment of very low blood sugar in adults and kids with diabetes, ages 2 and above.¹ It is premixed and ready to go, which means it is easy to use.² With 99% of people being able to use Gvoke HypoPen correctly, it offers a reliable method of delivery with proven results.²

The entire Xeris team remains grateful to the diabetes community for the support, enthusiasm and partnership as we celebrate this important milestone.

This media kit offers information related to Xeris and its ready-to-use solutions to help patients better manage diabetes.

We invite you to visit GvokeGlucagon.com to stay updated on the latest news and announcements.

POSTING GUIDELINES

As a pharmaceutical manufacturer, communications regarding Xeris' products are subject to significant limitations. The FDA will hold a manufacturer responsible for statements made by third parties if they have a relationship with the company.

We do not require or encourage you to post about or promote Xeris or any Xeris product.

Hashtags or other disclosures that suggest that Xeris has paid you to post or to promote the company or its products are not accurate and should be avoided. **Please do not use “#Ad,” “#Sponsored,” “#Promoted” or any language that suggests a promotional role with the company.**

Any post about Xeris or a Xeris product must comply with applicable law and in accordance with FDA and FTC guidelines. Specifically, please do not make any claim or statement regarding the safety or effectiveness of a Xeris product without prior approval from Xeris.

If you have questions about posting guidelines, please email Jamie Fortune at jamief@themooreagency.com.

DIGITAL PLATFORMS

The Gvoke™ website and social media platforms contain the latest information, news and updates related to Gvoke. Visit these channels to learn more or directly share content.

Patient Website

GvokeGlucagon.com

Social Media Platforms

Facebook
Facebook.com/GvokeGlucagon

Instagram
Instagram.com/gvokeglucagon

Brand Hashtags

#Gvoke

#GvokeHypoPen

GVOKE HYPOPEN™ AVAILABILITY PRESS RELEASE

XERIS PHARMACEUTICALS ANNOUNCES GVOKE HYPOPEN™ – THE FIRST AUTOINJECTOR FOR SEVERE HYPOGLYCEMIA – NOW AVAILABLE

\$0 copay card available for eligible commercial patients

Approximately 78% of commercially insured and Medicare lives have unrestricted access to Gvoke HypoPen at launch

CHICAGO, IL, July 1, 2020 – Xeris Pharmaceuticals, Inc. (Nasdaq: XERS), a specialty pharmaceutical company leveraging its novel formulation technology platforms to develop and commercialize ready-to-use injectable and infusible drug formulations, today announced that Gvoke HypoPen™ (glucagon injection) is now available by prescription in the U.S. for the treatment of severe hypoglycemia in adults and children with diabetes ages 2 years and above. Gvoke HypoPen is the first ready-to-use glucagon in a premixed autoinjector, with no visible needle.

Gvoke HypoPen offers simple administration with the certainty of delivery. Studies have shown it is:

- Easy to use: premixed and ready-to-go
- A reliable method of delivery: 99% of people were able to use it correctly
- Proven to work: 99% of adults and 100% of kids had their blood sugars raised to safe levels.

Gvoke HypoPen is available in two doses: 0.5 mg/0.1 mL for children (who weigh less than 100 pounds) and 1 mg/0.2 mL for adolescents and adults (who weigh 100 pounds or greater).

"We are excited to announce that Gvoke HypoPen is now available. The simplicity and reliability of Gvoke HypoPen has the potential to change people's ability to confidently respond to a severe hypoglycemic event in a timely manner," said Paul R. Edick, Chairman and Chief Executive Officer of Xeris Pharmaceuticals. "In addition, as we prepared for launch, we had a heightened focus on ensuring Gvoke HypoPen is covered by insurance. Currently, approximately 78% of commercially insured and Medicare lives have unrestricted access to Gvoke HypoPen."

"Gvoke HypoPen allows the diabetes community to change how we approach treating severe low blood sugar events," said Bruce Bode, MD, FACE, Atlanta Diabetes Associates. "Anyone can use Gvoke HypoPen in two simple steps. That opens the door for some patients to even give it to themselves, in certain situations. My hope is that what was once considered a crisis moment, can now become a manageable situation with Gvoke HypoPen."

Xeris is committed to ensuring that patients have access to this important new advancement. For a limited time, eligible commercially insured patients may pay as little as \$0 for a two-pack of Gvoke HypoPen by using the Gvoke® copay savings card*. Xeris also offers a Patient Assistance Program to help those who qualify to get Gvoke.

Please visit www.GvokeGlucagon.com to learn more.

**Offer not valid for prescriptions reimbursed under Medicaid, a Medicare drug benefit plan, TRICARE, or other federal or state health programs (such as medical assistance programs).*

INDICATION AND IMPORTANT SAFETY INFORMATION

GVOKE® is indicated for the treatment of severe hypoglycemia in adult and pediatric patients with diabetes ages 2 years and above.

IMPORTANT SAFETY INFORMATION

Contraindications

GVOKE is contraindicated in patients with pheochromocytoma, insulinoma, and known hypersensitivity to glucagon or to any of the excipients in GVOKE. Allergic reactions have been reported with glucagon and include anaphylactic shock with breathing difficulties and hypotension.

Warnings and Precautions

GVOKE is contraindicated in patients with pheochromocytoma because glucagon may stimulate the release of catecholamines from the tumor. If the patient develops a dramatic increase in blood pressure and a previously undiagnosed pheochromocytoma is suspected, 5 to 10 mg of phentolamine mesylate, administered intravenously, has been shown to be effective in lowering blood pressure.

In patients with insulinoma, administration of glucagon may produce an initial increase in blood glucose; however, GVOKE administration may directly or indirectly (through an initial rise in blood glucose) stimulate exaggerated insulin release from an insulinoma and cause hypoglycemia. GVOKE is contraindicated in patients with insulinoma. If a patient develops symptoms of hypoglycemia after a dose of GVOKE, give glucose orally or intravenously.

Allergic reactions have been reported with glucagon. These include generalized rash, and in some cases, anaphylactic shock with breathing difficulties and hypotension. GVOKE is contraindicated in patients with a prior hypersensitivity reaction.

GVOKE is effective in treating hypoglycemia only if sufficient hepatic glycogen is present. Patients in states of starvation, with adrenal insufficiency or chronic hypoglycemia, may not have adequate levels of hepatic glycogen for GVOKE administration to be effective. Patients with these conditions should be treated with glucose.

Necrolytic migratory erythema (NME), a skin rash commonly associated with glucagonomas, has been reported post-marketing following continuous glucagon infusion and resolved with discontinuation of the glucagon. Should NME occur, consider whether the benefits of continuous glucagon infusion outweigh the risks. Glucagon administered to patients with glucagonoma may cause secondary hypoglycemia.

Adverse Reactions

Most common (≥5%) adverse reactions associated with GVOKE are nausea, vomiting, injection site edema (raised 1 mm or greater), and hypoglycemia.

Drug Interactions

Patients taking beta-blockers may have a transient increase in pulse and blood pressure when given GVOKE. In patients taking indomethacin, GVOKE may lose its ability to raise blood

glucose or may even produce hypoglycemia. GVOKE may increase the anticoagulant effect of warfarin.

Please see full Prescribing Information for GVOKE on www.xerispharma.com. Manufactured for Xeris Pharmaceuticals, Inc. by Pyramid Laboratories Inc., Costa Mesa, CA 92626.

About Severe Hypoglycemia

Hypoglycemic events of any severity are a daily concern for people with diabetes. Mild or moderate hypoglycemia can occur multiple times a month. Severe hypoglycemia is characterized by severe cognitive impairment, requiring external assistance for recovery, and can be extremely frightening for patients and caregivers. Severe hypoglycemia can result in cardiovascular disease, seizure, coma, and, if left untreated, death. These severe hypoglycemic events can occur multiple times a year. Such events require emergency assistance from another person or caregiver such as a family member, friend, or co-worker.

About Glucagon

Glucagon is a metabolic hormone secreted by the pancreas that raises blood glucose levels by causing the liver to rapidly convert glycogen (the stored form of glucose) into glucose, which is then released into the bloodstream. Glucagon and insulin are two critical hormones in a glycemic control system that keep blood glucose at the right level in healthy individuals. In people with diabetes who are dependent on insulin, this control system is disrupted, and insulin must be injected to avoid high levels of blood glucose (hyperglycemia). The opposite effect, or low blood glucose (hypoglycemia), is also prevalent in this population due to dysregulated glucagon secretion. Severe hypoglycemia is a serious condition and can lead to seizures, coma, potential brain injury and, if untreated, death.

Glucagon is the standard of care for treating severe hypoglycemia. According to the American Diabetes Association, glucagon should be prescribed for all individuals at increased risk of clinically significant hypoglycemia, defined as blood glucose <54 mg/dL (3.0 mmol/L). Leveraging XeriSol™, one of Xeris' two proprietary formulation technology platforms, Xeris has the potential to provide the first ready-to-use, room-temperature stable liquid glucagon for use by people with diabetes and other conditions to prevent or manage various forms of hypoglycemia and improve glucose control.

About Xeris Pharmaceuticals, Inc.

Xeris (Nasdaq: XERS) is a specialty pharmaceutical company delivering innovative solutions to simplify the experience of administering important therapies that people rely on every day around the world.

With a novel technology platform that enables ready-to-use, room-temperature stable formulations of injectable and infusible therapies, the company is advancing a portfolio of solutions in various therapeutic categories, including its first commercial product, Gvoke®. Its proprietary XeriSol™ and XeriJect™ formulation technologies have the potential to offer distinct advantages over conventional product formulations, including eliminating the need for reconstitution, enabling long-term, room-temperature stability, significantly reducing injection volume, and eliminating the requirement for intravenous (IV) infusion. With Xeris' technology, new product formulations are designed to be easier to use by patients, caregivers, and health practitioners and help reduce costs for payers and the healthcare system.

Xeris is headquartered in Chicago, IL. For more information, visit www.xerispharma.com, or follow us on Twitter, LinkedIn or Instagram.

Forward-looking Statements

Any statements in this press release about future expectations, plans and prospects for Xeris Pharmaceuticals, Inc., including statements regarding the availability and acceptance of Gvoke[®] in the marketplace, the market and therapeutic potential of its product candidates, the timing or likelihood of commercialization of its product candidates, the potential utility of its formulation platforms and other statements containing the words "will," "would," "continue," and similar expressions, constitute forward-looking statements within the meaning of The Private Securities Litigation Reform Act of 1995. Actual results may differ materially from those indicated by such forward-looking statements as a result of various important factors, including, without limitation, the regulatory approval of its product candidates, its ability to market and sell its products, if approved, and other factors discussed in the "Risk Factors" section of the most recently filed Quarterly Report on Form 10-Q filed with the Securities and Exchange Commission, as well as discussions of potential risks, uncertainties, and other important factors in Xeris' subsequent filings with the Securities and Exchange Commission. Any forward-looking statements contained in this press release speak only as of the date hereof, and Xeris expressly disclaims any obligation to update any forward-looking statements, whether as a result of new information, future events or otherwise.

The Company intends to use the investor relations portion of its website as a means of disclosing material non-public information and for complying with disclosure obligations under Regulation FD.

Investor Contact

Allison Wey
Senior Vice President, Investor Relations and Corporate Communications
away@xerispharma.com
312-736-1237

IMPORTANT SAFETY INFORMATION ABOUT GVOKE

INDICATION AND SAFETY SUMMARY

GVOKE is a prescription medicine used to treat very low blood sugar (severe hypoglycemia) in adults and kids with diabetes ages 2 years and above. It is not known if GVOKE is safe and effective in children under 2 years of age.

WARNINGS

Do not use GVOKE if:

- you have a tumor in the gland on top of your kidneys (adrenal gland), called a pheochromocytoma.
- you have a tumor in your pancreas, called either an insulinoma or a glucagonoma.
- you are allergic to glucagon or any other inactive ingredient in GVOKE.

GVOKE MAY CAUSE SERIOUS SIDE EFFECTS, INCLUDING:

High blood pressure. GVOKE can cause high blood pressure in certain people with tumors in their adrenal glands.

Low blood sugar. GVOKE can cause low blood sugar in certain people with tumors in their pancreas.

Serious skin rash. GVOKE can cause a serious skin rash in certain people with a tumor in their pancreas called a glucagonoma.

Serious allergic reaction. Call your doctor or **get medical help right away** if you have a serious allergic reaction including:

- rash
- difficulty breathing
- low blood pressure

COMMON SIDE EFFECTS

The most common side effects of GVOKE include:

- nausea
- vomiting
- swelling at the injection site
- headache

These are not all the possible side effects of GVOKE. For more information, ask your doctor.

Call your doctor for medical advice about side effects. **You are encouraged to report side effects of prescription drugs to the FDA. Visit www.fda.gov/medwatch, or call 1-800-FDA-1088.**

BEFORE USING

Before using GVOKE, tell your doctor about all your medical conditions, including if you:

- have a tumor in your pancreas
- have not had food or water for a long time (prolonged fasting or starvation)

Tell your doctor about all the medicines you take, including prescription and over-the-counter medicines, vitamins, and herbal supplements.

HOW TO USE

- Read the detailed Instructions For Use that come with GVOKE.
- Make sure your caregiver knows where you keep your GVOKE and how to use GVOKE correctly before you need their help.
- Your doctor will tell you how and when to use GVOKE.
- GVOKE contains only 1 dose of medicine and cannot be reused.
- After administering GVOKE, the caregiver should call for emergency medical help right away.
- If the person does not respond after 15 minutes, another dose may be given.
- Tell your doctor each time you use GVOKE.
- Store GVOKE at temperatures between 68°F and 77°F. Do not keep it in the refrigerator or let it freeze.
- Keep GVOKE in the foil pouch until you are ready to use it.

Keep GVOKE and all medicines out of the reach of children.

For more information, call 1-877-937-4737 or go to www.GvokeGlucagon.com.

XERIS LEADERSHIP QUOTES

Paul R. Edick

Chairman & Chief Executive Officer

“The introduction of the Gvoke HypoPen™ represents the core of our purpose as a company – to make a difference in people’s lives by simplifying essential medications. Using our innovative technology and the simple autoinjector, a patient or anyone around them can quickly and effectively respond to a severe hypoglycemic event.”

Steven Prestrelski, Ph.D., MBA

Chief Scientific Officer

“Gvoke HypoPen™ is the result of years of dedicated research to overcome the limitations of conventional glucagon options and deliver a solution that will help so many families with diabetes. The Gvoke HypoPen gives people who experience hypoglycemia an important new tool, supported by clinical data that show it is a highly reliable, effective and simple solution to resolve a potentially dangerous situation.”

FIVE THINGS TO KNOW ABOUT GVOKE HYPOPEN™

1. Gvoke HypoPen is the first autoinjector for very low blood sugar. It is premixed and ready to go, so it is easy to use.¹
2. Gvoke HypoPen is used to treat very low blood sugar in adults and kids with diabetes ages 2 and above.²
3. It is a reliable method of delivery, that is proven to work – 99% of people were able to give Gvoke HypoPen successfully, in usability studies.¹
4. Gvoke™ can be used when a person experiences any of the following²:

 <p>Have tried correcting with food or drink and it isn't working</p>	 <p>Are unable to swallow safely</p>	 <p>Feel like passing out</p>	 <p>Pass out or have a seizure</p>
--	---	---	---

5. It's important to remember that Gvoke can be used even before you or the person you're helping passes out or has a seizure. It's a good idea for you and the people in your life to know how to use it before you need it.

Gvoke should be stored at room temperature. Do not refrigerate or freeze Gvoke.²

GVOKE HYPOPEN FREQUENTLY ASKED QUESTIONS



Frequently Asked Questions

Product Overview

What is Gvoke HypoPen?

Gvoke HypoPen is the first autoinjector for low blood sugar emergencies in people with diabetes, ages 2 and above.¹ It's premixed and ready-to-go, so it's easy to use.¹ Anyone can use Gvoke HypoPen with 2 simple steps.² It's available in 2 doses (one for kids and one for adults), and no refrigeration is required.

Who is at risk of severe low blood sugar?

There are many reasons that people may be at risk for severe low blood sugar. You may be at a higher risk if you take insulin or sulfonylurea to help you manage your diabetes, exercise at an intense level, tend to skip meals, have an inconsistent schedule, stressed, have tight blood sugar goals, tend to have insulin pump problems, are more sensitive to insulin, had severe low blood sugar in the past, have a hard time recognizing signs that your blood sugar is low, had diabetes for a long time, or have trouble taking your medicine.³⁻⁵

When should I use Gvoke™?

Gvoke can be used to treat a severe low blood sugar event when someone¹:

1. Has repeatedly tried correcting with food or drink and it isn't working
2. Is unable to swallow safely
3. Feels like you/they might pass out
4. Experiences loss of consciousness or seizure

It's important to remember that Gvoke can be used even before you or the person you're helping passes out or has a seizure. It's a good idea for you and the people in your life to know how to use it, before you need it.

Are there any side effects with Gvoke?

The most common side effects for adults were nausea (30%), vomiting (16%), and headache (5%).¹ The most common side effects for kids were nausea (45%), hypoglycemia (39%), vomiting (19%), headache (7%), abdominal pain (3%), hyperglycemia (7%), injection site discomfort (3%), injection site reaction (3%), and urticaria (hives) (3%).¹ Most side effects were mild. If an adult ended up having a side effect, it was mild 81% of the time. If a kid ended up having a side effect, it was mild 83% of the time.⁶

How is Gvoke different from a traditional glucagon kit?

Gvoke is premixed and ready-to-go. It is also available as a 0.5 mg/0.1 mL kids dose and 1 mg/0.2 mL adult dose.¹

Continued on the next page

Please see the Important Safety Information on page 18.



What is the difference between Gvoke™ Prefilled Syringe (PFS) and Gvoke HypoPen?

Gvoke PFS and Gvoke HypoPen are both for the treatment of low blood sugar emergencies in people with diabetes, ages 2 and above.¹ They are both premixed and ready-to-go so they are easy to use.¹ One comes as a prefilled syringe with a 1/2 inch visible needle,² and one comes as an autoinjector with no visible needle. Both options can be used with 2 simple steps.^{2,7}

Product Usage

How do you use Gvoke HypoPen?²



After using Gvoke, you should lay or be turned on your side and call for emergency help.

Can Gvoke be injected through clothing?

No, Gvoke should only be injected directly on exposed skin and can be injected into the upper arm, lower stomach or outer thigh.²

Why do I need to call for emergency help after using Gvoke?

It is recommended that anyone who suffers a severe hypoglycemic event seek help afterwards to check for proper glucose levels and to plan future treatment adjustments.¹

Dosing Options

Is there a Gvoke available specifically for kids?

Yes, there is a kids-specific dose. Gvoke is available in a 0.5 mg/0.1 mL dose for kids <12 years of age. For children under 12 years of age who weigh ≥100 lbs, a 1 mg/0.2 mL dose is recommended.¹

Talk to your doctor about which dose is appropriate for your child.

What doses are available for adolescents and adults?

Gvoke is available in a 1 mg/0.2 mL dose for adolescent and adult patients ≥12 years of age.¹

Please see the Important Safety Information on page 18.



Storage and Handling

How should I store Gvoke™?

Gvoke should be stored in the original foil pouch until time of use and should be kept at room temperature: 20°C to 25°C (68°F to 77°F). Do not refrigerate or freeze Gvoke.¹

What is the shelf life of Gvoke?

Gvoke can be stored in the original packaging for up to 2 years from the date of manufacture. You should always check the expiration date on the label to make sure that your Gvoke has not expired.⁶

Can I store Gvoke in the refrigerator?

No, do not refrigerate or freeze Gvoke. Gvoke should be stored at room temperature.¹

Can I still use Gvoke if I remove it from the pouch but don't use it right away?

Gvoke should be kept in the original sealed foil pouch to protect it from light and moisture until time of use.² If removed from the foil pouch and not used immediately as directed, please contact your physician to obtain a new prescription for Gvoke. Properly dispose of the opened Gvoke in a sharps container after the replacement arrives.²

How should Gvoke be discarded?

After use, Gvoke should be kept in a safe place until it can be disposed of into an FDA-cleared sharps container.²

Cost and Access

Can Xeris help me with the cost of Gvoke?

If you have commercial insurance, you may be eligible for financial assistance with the Gvoke Copay Card.*

Xeris also offers a Patient Assistance Program to assist qualifying patients who can't afford their medications in obtaining Gvoke at no cost. Please call 1-877-myGvoke (1-877-694-8653) for more information.

*Terms and conditions may apply. Please visit GvokeGlucagon.com for more information.

How can I get Gvoke?

Gvoke is available with a prescription at your local pharmacy, as well as through home delivery. If you are interested in home delivery, you can place an order at GvokeGlucagon.com.

Please see the Important Safety Information on page 18.

INDICATION AND SAFETY SUMMARY

GVOKE is a prescription medicine used to treat very low blood sugar (severe hypoglycemia) in adults and kids with diabetes ages 2 years and above. It is not known if GVOKE is safe and effective in children under 2 years of age.

WARNINGS

Do not use GVOKE if:

- you have a tumor in the gland on top of your kidneys (adrenal gland), called a pheochromocytoma.
- you have a tumor in your pancreas, called either an insulinoma or a glucagonoma.
- you are allergic to glucagon or any other inactive ingredient in GVOKE.

GVOKE MAY CAUSE SERIOUS SIDE EFFECTS, INCLUDING:

High blood pressure. GVOKE can cause high blood pressure in certain people with tumors in their adrenal glands.

Low blood sugar. GVOKE can cause low blood sugar in certain people with tumors in their pancreas.

Serious skin rash. GVOKE can cause a serious skin rash in certain people with a tumor in their pancreas called a glucagonoma.

Serious allergic reaction. Call your doctor or **get medical help right away** if you have a serious allergic reaction including:

- rash
- difficulty breathing
- low blood pressure

COMMON SIDE EFFECTS

The most common side effects of GVOKE include:

- nausea
- vomiting
- swelling at the injection site
- headache

These are not all the possible side effects of GVOKE. For more information, ask your doctor. Call your doctor for medical advice about side effects. **You are encouraged to report side effects of prescription drugs to the FDA. Visit www.fda.gov/medwatch, or call 1-800-FDA-1088.**

BEFORE USING

Before using GVOKE, tell your doctor about all your medical conditions, including if you:

- have a tumor in your pancreas
- have not had food or water for a long time (prolonged fasting or starvation)

Tell your doctor about all the medicines you take, including prescription and over-the-counter medicines, vitamins, and herbal supplements.

HOW TO USE

- Read the detailed Instructions For Use that come with GVOKE.
- Make sure your caregiver knows where you keep your GVOKE and how to use GVOKE correctly before you need their help.
- Your doctor will tell you how and when to use GVOKE.
- GVOKE contains only 1 dose of medicine and cannot be reused.
- After administering GVOKE, the caregiver should call for emergency medical help right away.
- If the person does not respond after 15 minutes, another dose may be given.
- Tell your doctor each time you use GVOKE.
- Store GVOKE at temperatures between 68°F and 77°F. Do not keep it in the refrigerator or let it freeze.
- Keep GVOKE in the foil pouch until you are ready to use it.

Keep GVOKE and all medicines out of the reach of children.

For more information, call 1-877-937-4737 or go to www.GvokeGlucagon.com.

Please see the **Important Facts** about Gvoke.

REFERENCES: 1. Gvoke [prescribing information]. Chicago, IL: Xeris Pharmaceuticals, Inc. 2. Gvoke HypoPen [instructions for use]. Chicago, IL: Xeris Pharmaceuticals, Inc. 3. National Institute of Diabetes and Digestive and Kidney Diseases. Low blood glucose (hypoglycemia). 2016. <https://www.niddk.nih.gov/health-information/diabetes/overview/preventing-problems/low-blood-glucose-hypoglycemia>. Accessed May 28 2019. 4. Kedia N. Treatment of severe diabetic hypoglycemia with glucagon: an underutilized therapeutic approach. Diabetes Metab Syndr Obes. 2011;4:337-346. 5. Geller AI, Shehab N, Lovegrove MC, et al. National estimates of insulin-related hypoglycemia and errors leading to emergency department visits and hospitalizations. JAMA Intern Med. 2014;174(5):678-686. 6. Data on file. Chicago, IL: Xeris Pharmaceuticals, Inc. 7. Gvoke PFS [instructions for use]. Chicago, IL: Xeris Pharmaceuticals, Inc.

Gvoke, Gvoke HypoPen, their associated logos, Xeris Pharmaceuticals, and the Xeris Pharmaceuticals logo are trademarks of Xeris Pharmaceuticals, Inc.

Copyright ©2020 Xeris Pharmaceuticals, Inc. All rights reserved. US-GVKHP-20-00030 05/20

GVOKE HYPOPEN VISUAL ASSETS

Please email Jamie Fortune at jamief@themooreagency.com to request the Gvoke HypoPen logo and/or Gvoke HypoPen images.



Gvoke HypoPen is available as Gvoke HypoPen 2-Pack™

GVOKE PRE-FILLED SYRINGE FREQUENTLY ASKED QUESTIONS



Frequently Asked Questions

Product Overview

What is Gvoke™ Pre-Filled Syringe (PFS)?

Glucagon is a hormone that works with your body to bring up your blood sugar to safe levels.¹ Gvoke PFS is a single-use glucagon syringe used to treat very low blood sugar in adults and kids with diabetes ages 2 and above. Gvoke is premixed, prefilled, premeasured, and ready to use.²

Who is at risk of severe low blood sugar?

Patients with diabetes on insulin are at risk of severe low blood sugar.³

When should I use Gvoke?

Gvoke is used to treat very low blood sugar (severe hypoglycemia) and should be used if you or your child⁴:

1. Have tried consuming food or drinks that are high in sugar and your/their blood sugar levels haven't improved
2. Are unable to eat sugar or sugar-sweetened products
3. Are having a seizure
4. Lose consciousness

Are there any side effects with Gvoke?

The most common side effects of Gvoke are nausea, vomiting, headache, temporary high blood sugar, pain or redness at the injection site, itching, stomach pain, and allergic reactions to glucagon or to one of the inactive ingredients in Gvoke.²

Of the side effects seen in adults, 81% were mild in nature, as were 83% of the side effects seen in people <18 years of age.⁵

How is Gvoke different from a traditional glucagon kit?

Gvoke is premixed, prefilled, and premeasured. It is also available as a 0.5 mg/0.1 mL kids dose and 1 mg/0.2 mL adult dose.²

Continued on the next page



Product Usage

How do you use Gvoke PFS?^{2,4}

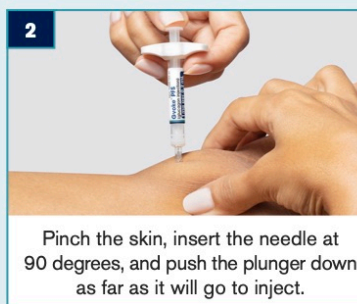
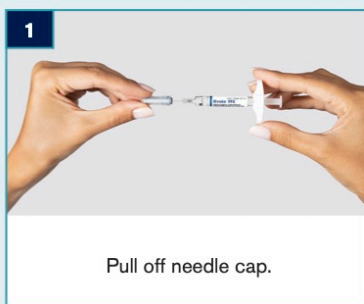

After using Gvoke PFS, turn person on his or her side and call for emergency medical help.

Can Gvoke be injected through clothing?

No, Gvoke should only be injected directly on exposed skin.⁴

Why do I need to call emergency medical help after using Gvoke?

It is recommended that anyone who suffers a severe hypoglycemic event seek help afterwards to check for proper glucose levels and to plan future treatment adjustments.^{2,4}

Dosing Options

Is there a Gvoke available specifically for kids?

Yes, there is a kids-specific dose. Gvoke is available in a 0.5 mg/0.1 mL dose for kids <12 years of age. For children under 12 years of age who weigh ≥100 lbs, a 1 mg/0.2 mL dose is recommended.² Talk to your doctor about which dose is appropriate for your child.²

What doses are available for adolescents and adults?

Gvoke is available in a 1 mg/0.2 mL dose for adolescent and adult patients ≥12 years of age.²

Please see the Important Safety Information on page 23.



Storage and Handling

How should I store Gvoke?

Gvoke should be stored in the original foil pouch until time of use and should be kept at room temperature: 20°C to 25°C (68°F to 77°F). Do not refrigerate or freeze Gvoke.²

What is the shelf life of Gvoke?

Gvoke can be stored in the original packaging for up to 2 years from the date of manufacture. You should always check the expiration date on the label to make sure that your Gvoke has not expired.^{2,5}

Can I store Gvoke in the refrigerator?

No, do not refrigerate or freeze Gvoke. Gvoke should be stored at room temperature.²

Can I still use Gvoke if I remove it from the pouch but don't use it right away?

Gvoke should be kept in the original sealed foil pouch to protect it from light and moisture until time of use. If removed from the foil pouch and not used immediately as directed, please contact your physician to obtain a new prescription for Gvoke.⁴ Properly dispose of the opened Gvoke in a sharps container after the replacement arrives.⁴

How should Gvoke be discarded?

After use, Gvoke should be kept in a safe place until it can be disposed of into an FDA-cleared sharps container.⁴

Cost and Access

Can Xeris help me with the cost of Gvoke?

If you have commercial insurance, you may be eligible for financial assistance with the Gvoke Copay Card.*

Xeris also offers a Patient Assistance Program to assist qualifying patients who can't afford their medications in obtaining Gvoke at no cost. Please call 1-800-myGvoke (1-800-694-8653) for more information.

*Terms and conditions may apply. Please visit GvokeGlucagon.com for more information.

How can I get Gvoke?

Gvoke will be available with a prescription at your local pharmacy, as well as through home delivery. If you are interested in home delivery, you can place an order at GvokeGlucagon.com.

Please see the Important Safety Information on page 23.

INDICATION AND SAFETY SUMMARY

GVOKE is a prescription medicine used to treat very low blood sugar (severe hypoglycemia) in adults and kids with diabetes ages 2 years and above. It is not known if GVOKE is safe and effective in children under 2 years of age.

WARNINGS

Do not use GVOKE if:

- you have a tumor in the gland on top of your kidneys (adrenal gland), called a pheochromocytoma.
- you have a tumor in your pancreas, called either an insulinoma or a glucagonoma.
- you are allergic to glucagon or any other inactive ingredient in GVOKE.

GVOKE MAY CAUSE SERIOUS SIDE EFFECTS, INCLUDING:

High blood pressure. GVOKE can cause high blood pressure in certain people with tumors in their adrenal glands.

Low blood sugar. GVOKE can cause low blood sugar in certain people with tumors in their pancreas.

Serious skin rash. GVOKE can cause a serious skin rash in certain people with a tumor in their pancreas called a glucagonoma.

Serious allergic reaction. Call your doctor or **get medical help right away** if you have a serious allergic reaction including:

- rash
- difficulty breathing
- low blood pressure

COMMON SIDE EFFECTS

The most common side effects of GVOKE include:

- nausea
- vomiting
- swelling at the injection site
- headache

These are not all the possible side effects of GVOKE. For more information, ask your doctor. Call your doctor for medical advice about side effects. **You are encouraged to report side effects of prescription drugs to the FDA. Visit www.fda.gov/medwatch, or call 1-800-FDA-1088.**

BEFORE USING

Before using GVOKE, tell your doctor about all your medical conditions, including if you:

- have a tumor in your pancreas
- have not had food or water for a long time (prolonged fasting or starvation)

Tell your doctor about all the medicines you take, including prescription and over-the-counter medicines, vitamins, and herbal supplements.

HOW TO USE

- Read the detailed Instructions For Use that come with GVOKE.
- Make sure your caregiver knows where you keep your GVOKE and how to use GVOKE correctly before you need their help.
- Your doctor will tell you how and when to use GVOKE.
- GVOKE contains only 1 dose of medicine and cannot be reused.
- After administering GVOKE, the caregiver should call for emergency medical help right away.
- If the person does not respond after 15 minutes, another dose may be given.
- Tell your doctor each time you use GVOKE.
- Store GVOKE at temperatures between 68°F and 77°F. Do not keep it in the refrigerator or let it freeze.
- Keep GVOKE in the foil pouch until you are ready to use it.

Keep GVOKE and all medicines out of the reach of children.

For more information, call 1-877-937-4737 or go to www.GvokeGlucagon.com.

Please see the [Important Facts](#) about Gvoke.

REFERENCES: 1. American Diabetes Association. Hypoglycemia (low blood sugar). <https://www.diabetes.org/diabetes/medication-management/blood-glucose-testing-and-control/hypoglycemia>. Accessed September 3, 2019. 2. Gvoke [prescribing information]. Chicago, IL: Xeris Pharmaceuticals, Inc. 3. National Institute of Diabetes and Digestive and Kidney Diseases. Hypoglycemia. <https://www.niddk.nih.gov/health-information/diabetes/overview/preventing-problems/low-blood-glucose-hypoglycemia>. Published August 2016. Accessed September 3, 2019. 4. Gvoke Pre-Filled Syringe [instructions for use]. Chicago, IL: Xeris Pharmaceuticals, Inc. 5. Data on file. Chicago, IL: Xeris Pharmaceuticals, Inc.

Gvoke, Gvoke HypoPen, their associated logos, Xeris Pharmaceuticals, and the Xeris Pharmaceuticals logo are trademarks of Xeris Pharmaceuticals, Inc.

©2019 Xeris Pharmaceuticals, Inc. All rights reserved. US-GVK-19-00127 09/19

GVOKE PRE-FILLED SYRINGE VISUAL ASSETS

Gvoke also offers a prefilled syringe presentation, Gvoke PFS.

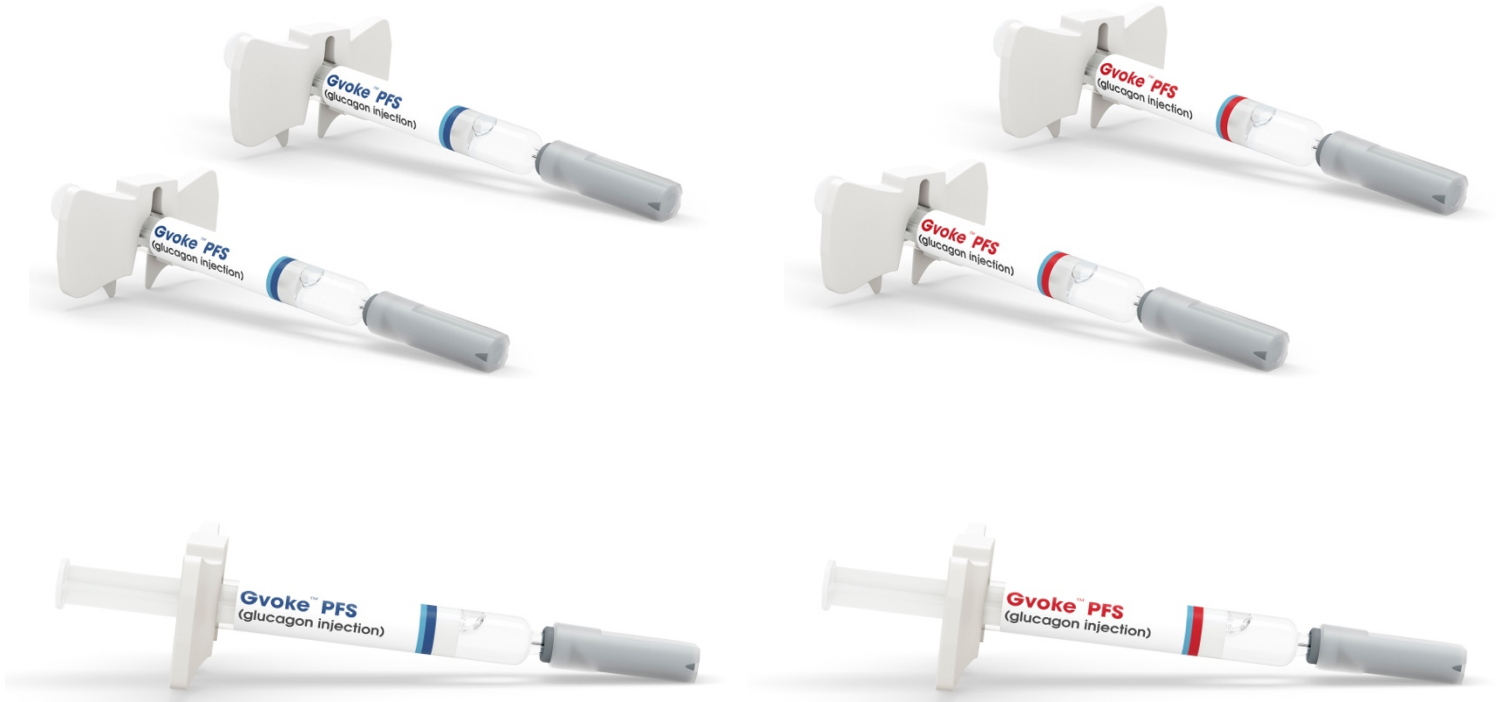

Gvoke PFS is available as Gvoke PFS 1-Pack™ and Gvoke PFS 2-Pack™



Gvoke™, Gvoke HypoPen™, Gvoke HypoPen 2-Pack™, Xeris Pharmaceuticals® and their associated logos are trademarks of Xeris Pharmaceuticals, Inc.

Copyright ©2020 Xeris Pharmaceuticals, Inc. All rights reserved. US-PR-20-00004 09/20